



OWNER'S MANUAL

REMOTE CONTROL

WINDOW AIR CONDITIONERS



MODELS: 1PACU8000 / 1PACU10000 / 1PACU12000

CONTENTS

REMOTE CONTROL SPECIFICATIONS	3
HANDLING THE REMOTE CONTROLLER	4
BUTTONS AND FUNCTIONS	5
REMOTE SCREEN INDICATORS	6
HOW TO USE BASIC FUNCTIONS	7
HOW TO USE ADVANCED FUNCTIONS	10

IMPORTANT NOTE:

Read the manual carefully before connecting your appliance. Make sure to save this manual for future reference. Illustrations in this manual are for explanatory purposes only, your actual app or air conditioner may look slightly different.

REMOTE CONTROL SPECIFICATIONS

Model	RG10G2(D2)/BGEFU1
Rated Voltage	3.0V (Dry batteries R03/LR03x2)
Signal Receiving Range	8m
Environment	23°F~140°F (-5°C~60°C)

QUICK START GUIDE

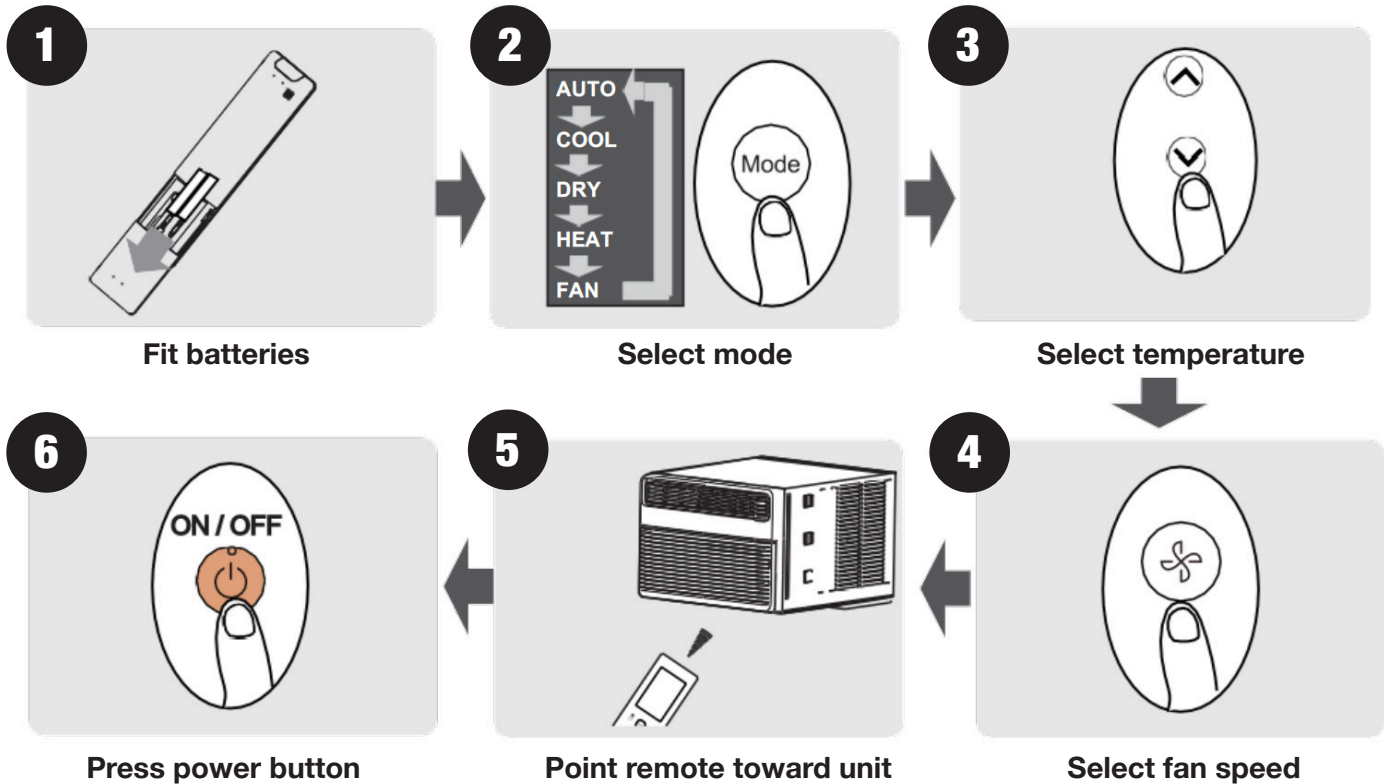

NOT SURE WHAT A FUNCTION DOES? Refer to the How to Use Basic Functions and How to Use Advanced Functions sections of this manual for a detailed description of how to use your air conditioner.

- Button designs on your unit may differ slightly from the example shown.
- If the indoor unit does not have a particular function, pressing that function's button on the remote control will have no effect.
- When there are wide differences between "Remote controller Manual" and "USER'S MANUAL" on function descriptions, the description of "USER'S MANUAL" shall prevail.

HANDLING THE REMOTE CONTROLLER

INSERTING AND REPLACING BATTERIES

Your air conditioning unit may come with two batteries. Put the batteries in the remote control before use.

- 1 Slide the back cover from the remote control downward, exposing the battery compartment.
- 2 Insert the batteries, paying attention to match up the (+) and (-) ends of the batteries with the symbols inside the battery compartment.
- 3 Slide the battery cover back into place.

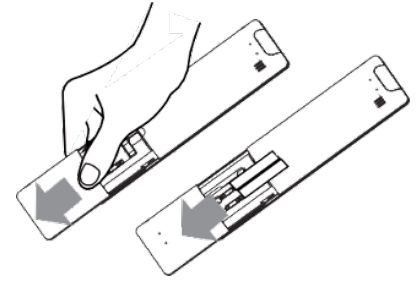

BATTERY NOTES: For optimum product performance:

- Do not mix old and new batteries, or batteries of different types.
- Do not leave batteries in the remote control if you don't plan on using the device for more than 2 months.

BATTERY DISPOSAL: Do not dispose of batteries in unsorted municipal waste. Refer to local laws for proper disposal of batteries.

TIPS FOR USING REMOTE CONTROL: The remote control must be used within 26 feet (8 m) of the unit.

- The unit will beep when remote signal is received.
- Curtains, other materials and direct sunlight can interfere with the infrared signal receiver.

NOTES FOR USING REMOTE CONTROL

The device could comply with the local national regulations.

- In Canada, it should comply with CAN ICES-3(B)/NMB-3(B).
- In the USA, this device complies with part 15 of the FCC Rules.

Operation is subject to the following two conditions:

- (1) This device may not cause harmful interference, and
- (2) this device must accept any interference received, including interference that may cause undesired operation.

This equipment has been tested and found to comply with the limits for a Class B digital device, pursuant to part 15 of the FCC Rules. These limits are designed to provide reasonable protection against harmful interference in a residential installation. This equipment generates, uses, and can radiate radio frequency energy and, if not installed and used following the instructions, may cause harmful interference to radio communications. However, there is no guarantee that interference will not occur in a particular installation. If this equipment does cause harmful interference to radio or television reception, which can be determined by turning the equipment off and on, the user is encouraged to try to correct the interference by one or more of the following measures:

- Reorient or relocate the receiving antenna. Increase the separation between the equipment and receiver.
- Connect the equipment into an outlet on a circuit different from that to which the receiver is connected.
- Consult the dealer or an experienced radio/TV technician for help.

Changes or modifications not approved by the party responsible for compliance could void the user's authority to operate the equipment.

BUTTONS AND FUNCTIONS

Before you begin using your new air conditioner, make sure to familiarize yourself with its remote control. The following is a brief introduction to the remote control itself. For instructions on how to operate your air conditioner, refer to the **How to Use Basic Functions** section of this manual.

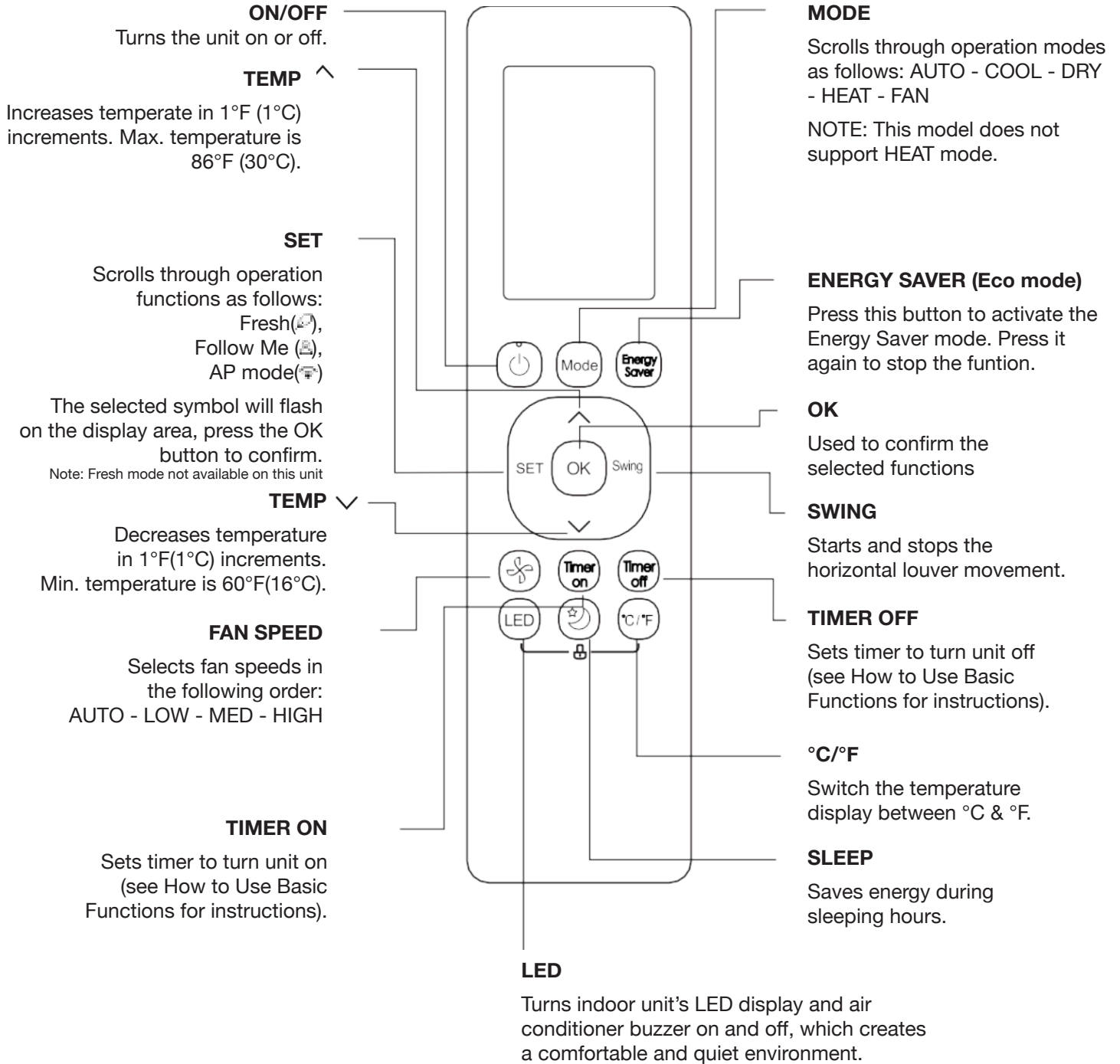

WARNING

Pressing the LED and °C/°F buttons at the same time will lock your remote and disable the buttons. If your remote is unresponsive, press these buttons at the same time for 5 seconds, then try to use the remote again.

REMOTE SCREEN INDICATORS

Information is displayed when the remote controller is power up.

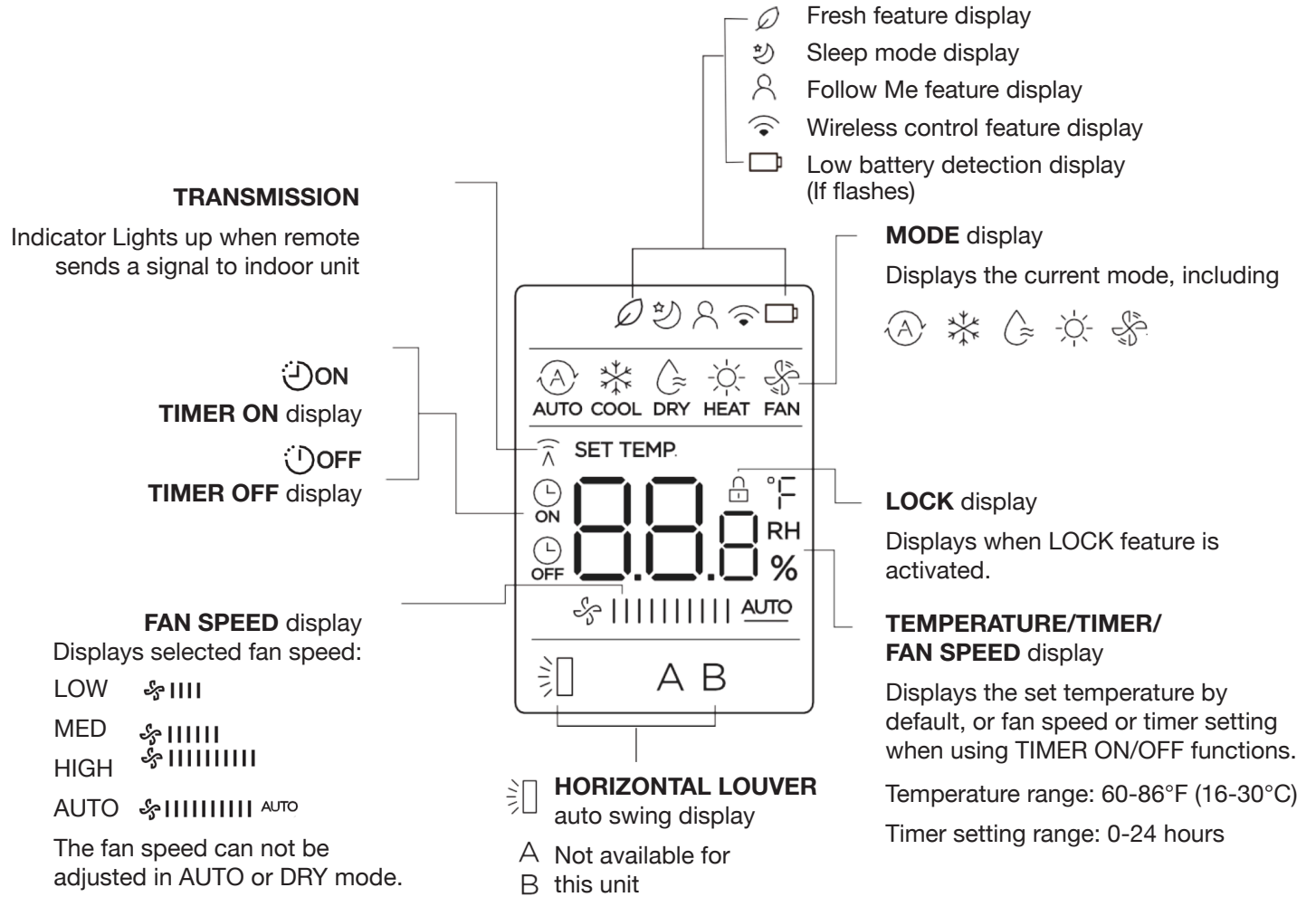

NOTE: All indicators shown in the figure are for illustration only. During the actual operation, only the relative function signs are shown on the display window.

HOW TO USE BASIC FUNCTIONS

BASIC OPERATION

ATTENTION! Before operation, please ensure the unit is plugged in and power is available.

SETTING TEMPERATURE

The operating temperature range for units is 60-86°F (16-30°C).
You can increase or decrease the set temperature in 1°F (1°C) increments.

AUTO MODE

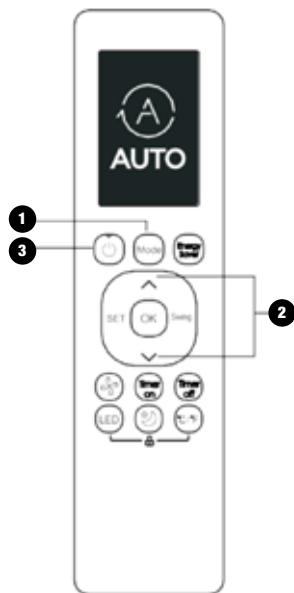

In AUTO mode, the unit will automatically select the COOL, FAN, or HEAT function based on the set temperature.

- 1 Press the MODE button to select AUTO.
- 2 Set your desired temperature using the button

NOTE: Fan speed cannot be changed in AUTO mode.

DRY MODE (DEHUMIDIFIER)

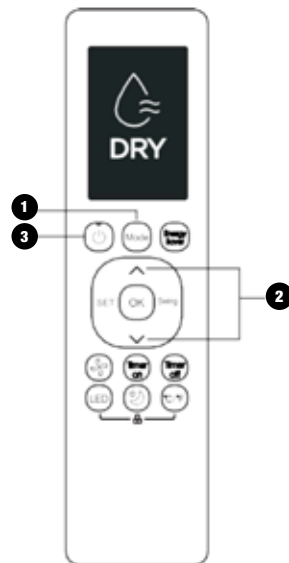

- 1 Press the MODE button to select DRY.
- 2 Set your desired temperature using the button

NOTE: Fan speed cannot be changed in DRY mode.

COOL MODE

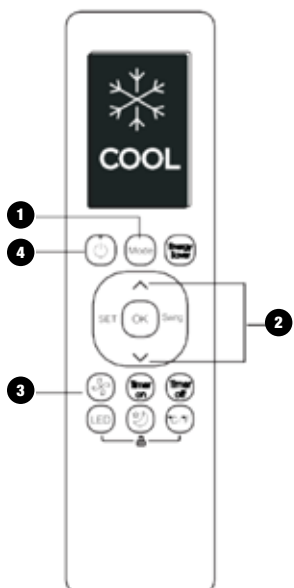

- 1 Press the MODE button to select COOL mode.
- 2 Set your desired temperature using the button
- 3 Press FAN button to select the fan speed: AUTO, LOW, MED, HIGH.

COOL MODE

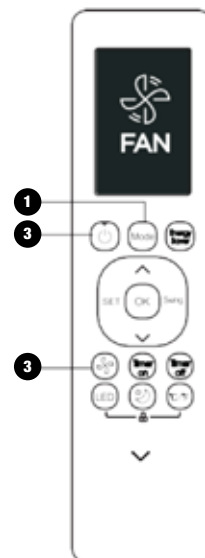

- 1 Press the MODE button to select COOL mode.
- 2 Press FAN button to select the fan speed: AUTO, LOW, MED, HIGH.

NOTE: The temperature cannot be set in FAN mode. As a result, your remote control's LCD screen will not display temperature.

SETTING THE TIMER

TIMER ON/OFF - Set the amount of time after which the unit will automatically turn on/off.

TIMER ON SETTING

Press TIMER ON button to initiate the ON time sequence.



Press the up or down button multiple times to set the desired time to turn on the unit



Point the remote at the unit and wait 1sec for TIMER ON to be activated.



TIMER OFF SETTING

Press TIMER OFF button to initiate the OFF time sequence.



Press the up or down button multiple times to set the desired time to turn off the unit



Point the remote at the unit and wait 1sec for TIMER OFF to be activated.



NOTE:

1. When setting TIMER ON or TIMER OFF, the time will increase in 30-minute increments with each press, up to 10 hours. After 10 hours it will increase in 1-hour increments (up to 24 hours total). For example: press 5 times to get 2.5h, and press 10 times to get 5h. The timer will revert to 0.0 after 24.
2. Cancel either function by setting its timer to 0.0h.

Keep in mind that the time period you set for both functions refers to hours after the current time.

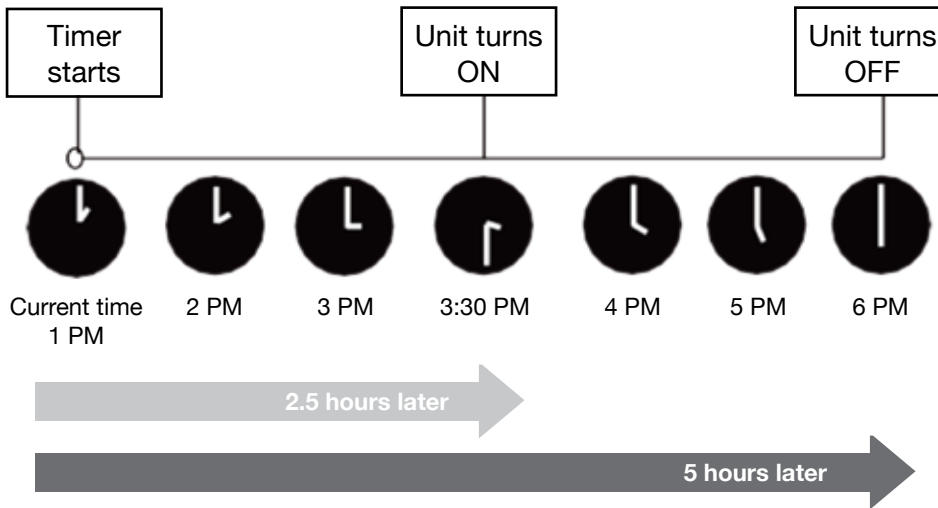
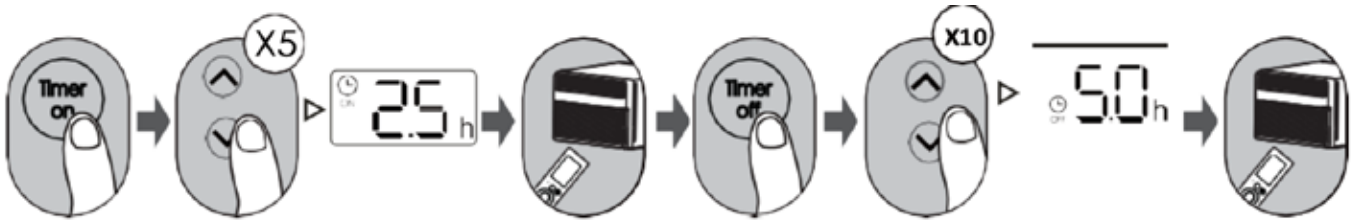

Example: If current time is 1:00PM, and the timer is set per the above steps, the unit will turn on 2.5h later (3:30PM) and turn off at 6:00PM.

HOW TO USE ADVANCED FUNCTIONS

SWING



The horizontal louver will swing up and down automatically. Press again to make it stop.

ENERGY SAVER (ECO MODE)



Press Energy saver button to turn on this function.
This function is available on COOL, DRY, AUTO modes.

°C/°F



Press this button to switch the temperature display between °C & °F.

LED DISPLAY



Turns the display on the indoor unit on and off.

SLEEP FUNCTION



The SLEEP function is used to decrease energy usage while you sleep and keep the room at a comfortable setting. This function can only be activated via remote control. For details, please see "sleep operation" in the user's manual.

NOTE: The SLEEP function is not available in FAN or DRY mode.

LOCK FUNCTION

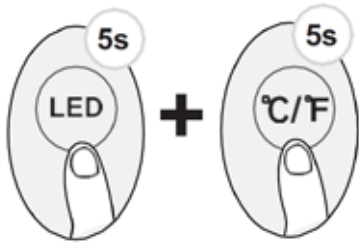

Press LED button and °C/°F button at the same time for 5 seconds to activate the Lock function and disable the remote buttons. Press these two buttons together for two seconds again to disable locking.

SET

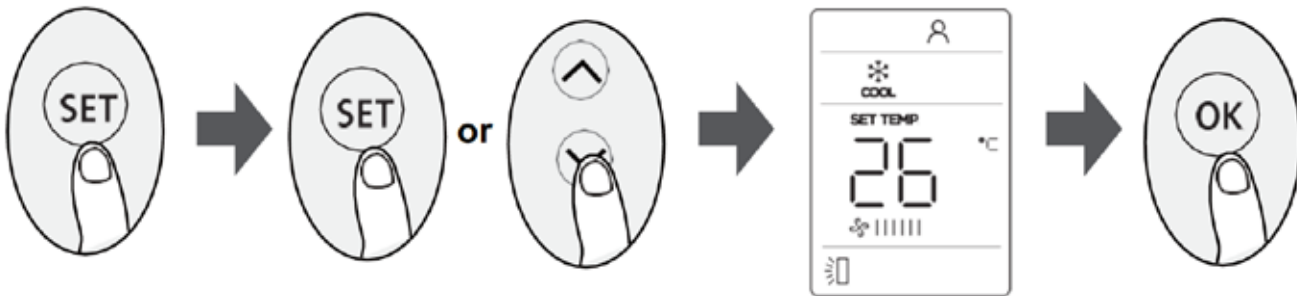

- Press the SET button to enter the function setting, then press the SET button or or button to select the desired function. The selected symbol will flash on the display area. Press the OK button to confirm.
- To cancel the selected function, just perform the same procedures as above.
- Press the SET button to scroll through operation functions as follows:
Fresh (🌿), Follow Me (👤), AP mode(📶)

FOLLOW ME FUNCTION (👤)

The Follow Me function enables the remote control to measure the temperature at its current location and send this signal to the air conditioner every 3 minutes. When using AUTO, COOL, or HEAT modes, measuring ambient temperature from the remote control (instead of from the indoor unit itself) will enable the air conditioner to optimize the temperature around you and ensure maximum comfort.

AP FUNCTION (📶) :

Choose AP mode to start the wireless network configuration.



5401 Dansher Road
Countryside, IL 60525

844-4PA-AIRE | 844-472-2473 | support@perfectaire.us
CANADA SUPPORT 877-997-2473 | supportcanada@perfectaire.us

www.perfectaire.us