

POWERFRESH[®] DELUXE

USER GUIDE
1806 SERIES

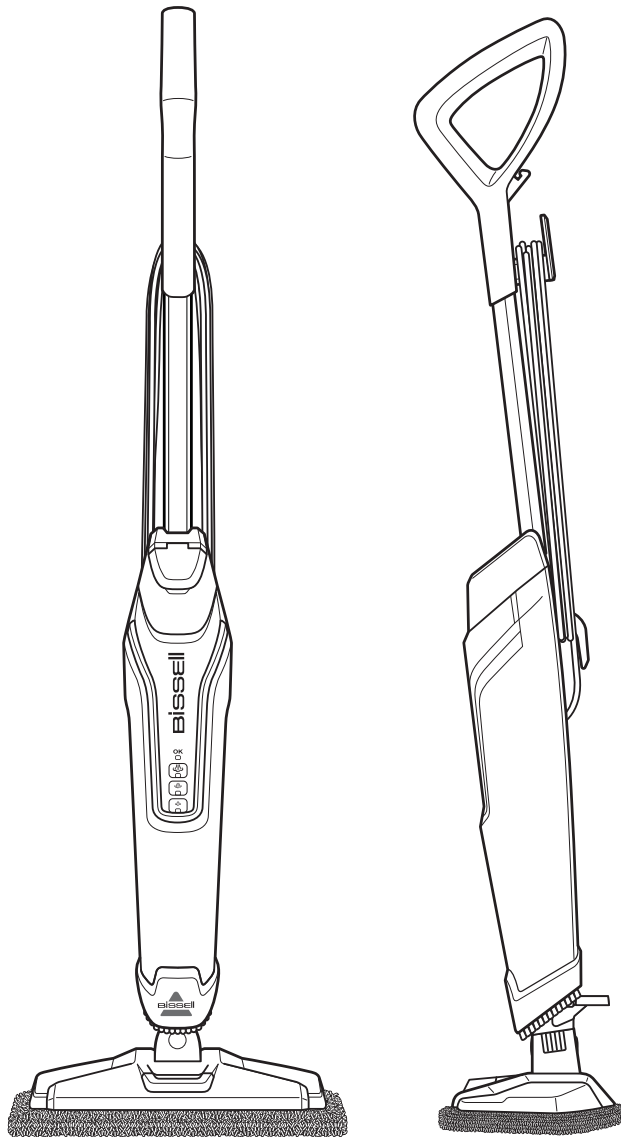

IMPORTANT SAFETY INSTRUCTIONS

READ ALL INSTRUCTIONS BEFORE USING YOUR STEAM MOP.

When using an electrical appliance, basic precautions should be observed, including the following:
Always connect to a polarized outlet (left slot is wider than right). Unplug from outlet when not in use and before conducting maintenance.

WARNING

TO REDUCE THE RISK OF FIRE, ELECTRIC SHOCK, OR INJURY:

- » Children should be supervised to ensure that they do not play with the appliance.
- » If the cord is damaged, it must be replaced by the manufacturer, its service agent or similarly qualified persons in order to avoid a hazard.
- » Use extra care when cleaning on stairs.
- » Do not use with damaged cord or plug.
- » Do not use outdoors.
- » Always turn off this appliance before connecting or disconnecting the nozzle. Do not direct steam at people, animals, or at electrical outlets.
- » Do not expose to rain.
- » Store indoors.
- » Unplug from outlet when not in use and before conducting maintenance or troubleshooting.
- » Do not leave steam cleaner unattended.
- » Do not expose hair, loose clothing, fingers or body parts to openings or moving parts.
- » Do not service steam cleaner when it is plugged in.
- » Do not handle steam cleaner with wet hands.
- » Do not use steam cleaner if it has been dropped, damaged, left outdoors or dropped into water, return it to a service center.
- » Do not pull or carry by cord, use cord as a handle, close door on cord, pull cord around sharp corners or edges, or expose cord to heated surfaces.
- » Do not unplug by pulling on cord.
- » Do not use appliance in an enclosed space filled with vapor given off by oil-base paint, paint thinner, some moth proofing substances, flammable dust, or other explosive or toxic vapors.
- » Do not allow to be used as a toy.
- » Do not use on leather, wax polished furniture or floors, synthetic fabrics, velvet or other delicate, steam-sensitive materials.
- » Do not immerse in water or liquid.
- » Not for space heating purposes.
- » Do not use for any purpose other than described in this User's Guide.
- » Use only manufacturer's recommended attachments - use of attachments not provided or sold by BISSELL may cause fire, electric shock or injury.
- » Never put descaling, aromatic, alcoholic, detergent or vinegar products into the steam cleaner, as this may damage it or make it unsafe for use.
- » Unplug by grasping the plug, not the cord.
- » Close attention is necessary when used by or near children.

SAVE THESE INSTRUCTIONS FOR FUTURE USE

This model is for household use only. Commercial use of this unit voids the manufacturer's warranty.

THIS APPLIANCE HAS A POLARIZED PLUG

To reduce the risk of electric shock, this appliance has a polarized plug (one blade is wider than the other). This plug will fit in a polarized outlet only one way. If the plug does not fit fully in the outlet, reverse the plug. If it still does not fit, contact a qualified electrician to install a proper outlet. Do not change the plug in any way.

Thanks for buying a BISSELL PowerFresh® Deluxe Steam Mop

We love to clean and we're excited to share one of our innovative products with you. We want to make sure your steam mop works as well in two years as it does today, so this guide has tips on how to use (pages 5-8), maintain (page 9), and if there is a problem, troubleshoot (page 10).

Your steam mop needs a little assembly before you can put it to work, so flip to page 5 and let's get started!

What's In The Box?

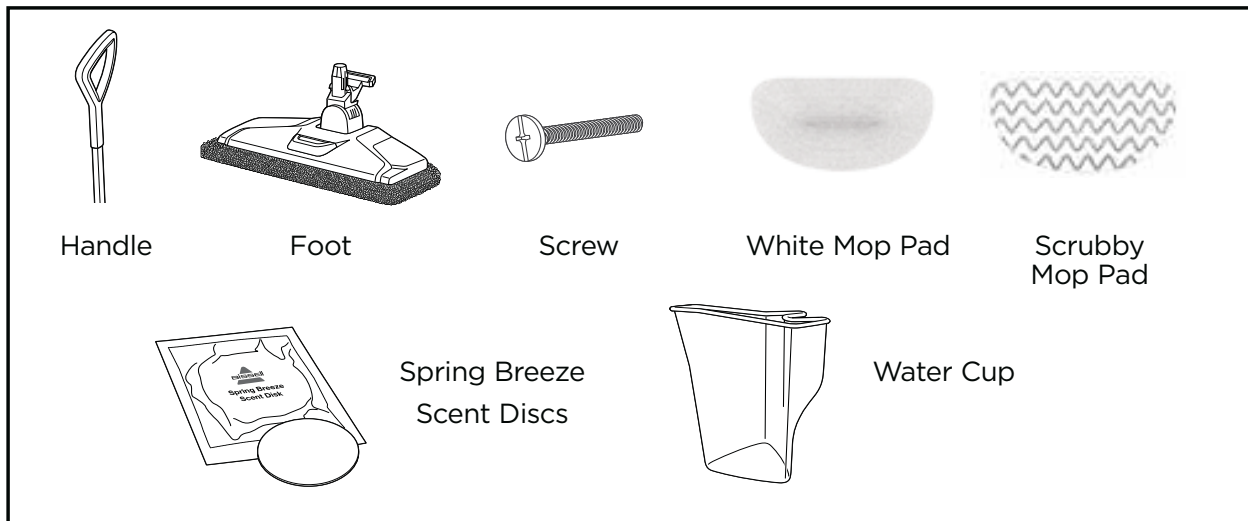

NOTE: Standard accessories may vary by model. To identify what should be included with your purchase, please refer to the “Carton Contents” list located on the carton top flap.

Safety Instructions.....	2	Troubleshooting	10
Product View.....	4	Warranty.....	11
Assembly	5	Service.....	11
Operations	5-8	Product Registration.....	12
Maintenance & Care	9	Consumer Care.....	12

Getting to Know Your PowerFresh® Deluxe

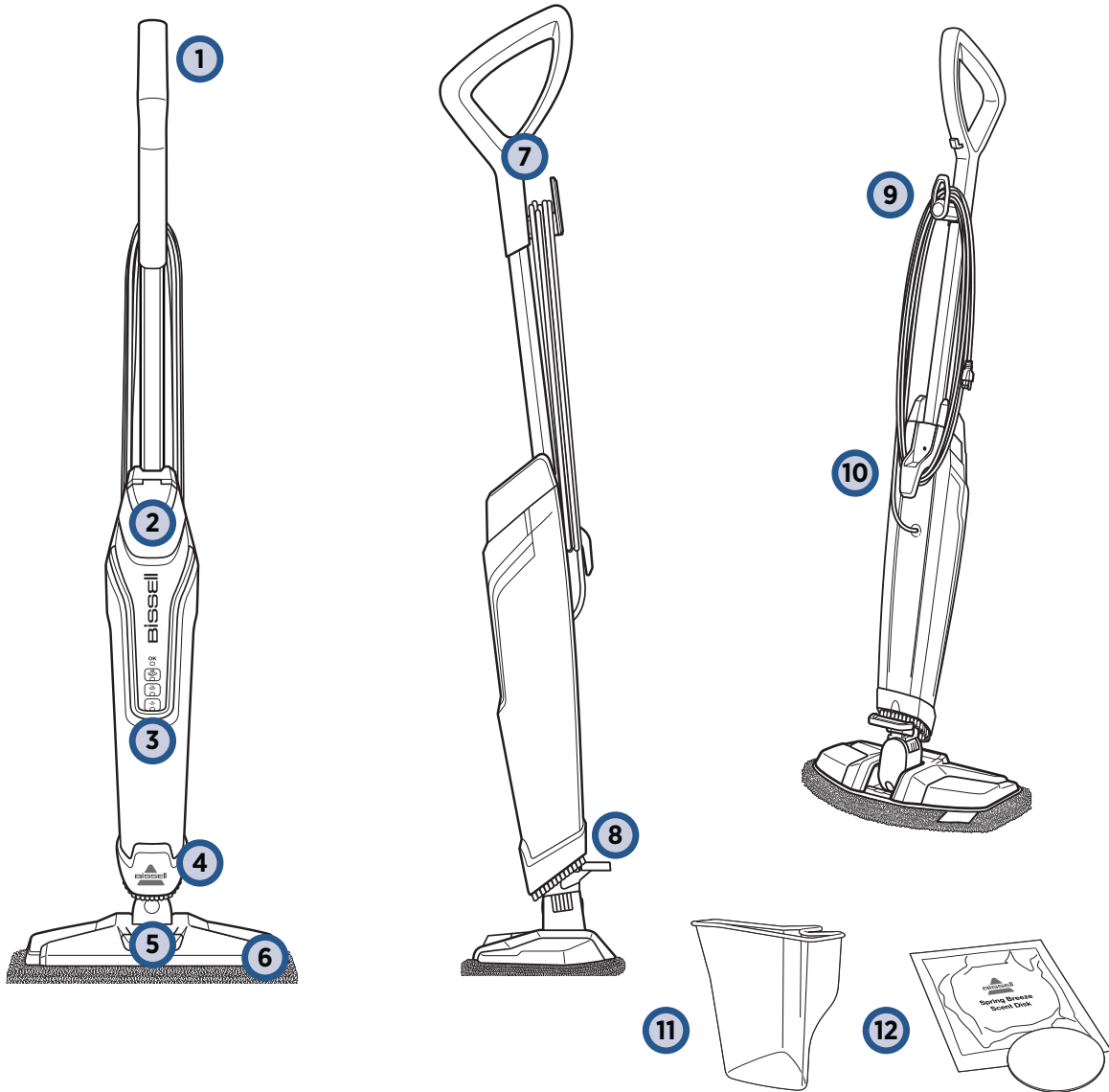

- 1 Strain Reliever Handle™
- 2 Easy Fill Water Tank
- 3 Smart Set Steam Control
- 4 SpotBoost™ Brush
- 5 Scent Disc Tray
- 6 Edge-Cleaning Mop Head

- 7 In-Use Cord Clip
- 8 Pedal to release SpotBoost™ Brush
- 9 Quick Release™ Cord Wrap
- 10 Lower Cord Wrap
- 11 Attachable Water Cup
- 12 Spring Breeze Scent Discs

Assembly

⚠️ WARNING

Do not plug in your PowerFresh® Deluxe Steam Mop until you are familiar with all instructions and operating procedures.

Your BISSELL PowerFresh® Deluxe Steam Mop assembles quickly and easily. It is packaged with the following items:

- Handle with one screw
- SpotBoost™ Brush
- Machine Foot
- 2 Microfiber Washable Mop Pads
- 2 Spring Breeze Scent Discs
- Water Cup

- 1** Attach lower body to mop head by snapping it into place.

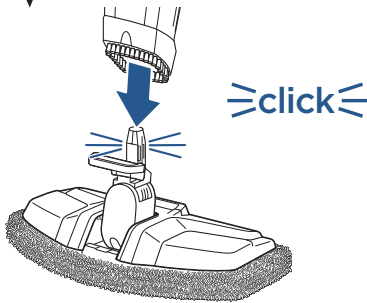

- 2** Then, insert handle into body of unit and screw until tightened.

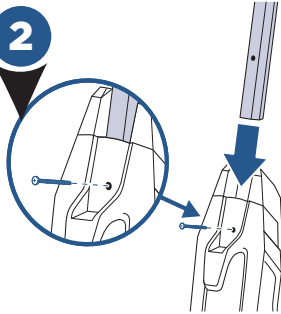

- 3** Wrap the cord around the quick release cord wrap and the lower cord wrap.

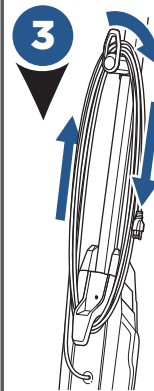

NOTE: To easily unwrap the cord for use, just turn the quick release cord wrap downward to remove the cord from the cord wrap.

Filling Your Water Tank

- 1** The clean water tank is located on the top of the body of the machine.

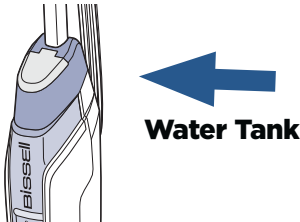

- 2** Lift the water tank cap straight up to open.

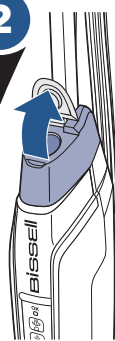

- 3** Use water cup provided and fill with distilled or demineralized water, recommended in place of tap water. Close the water tank cap after filling.

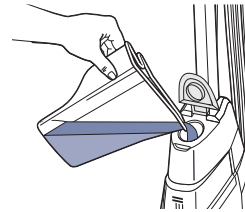

A few notes about filling the Water Tank:

- The Water Tank's capacity is 560 mL (19 oz). **DO NOT USE CHEMICALS IN THE WATER TANK OF YOUR POWERFRESH® DELUXE STEAM MOP.**

TIP: Use of distilled water or demineralized water is recommended to prolong the life of your hard floor cleaner. You can also add a fresh scent as you clean by using BISSELL demineralized waters in various scents like Citrus, Eucalyptus Mint and Spring Breeze.

Attaching Microfiber Mop Pads

- 1** Your PowerFresh® Deluxe Steam Mop may have come with two different pads.



White Mop Pad



Scrubby Mop Pad

The White Pad is best for everyday use on delicate flooring like sealed hardwoods and laminate. The Scrubby Pad is best to use for scrubbing heavily soiled floors and cleaning tougher messes.

- 2**

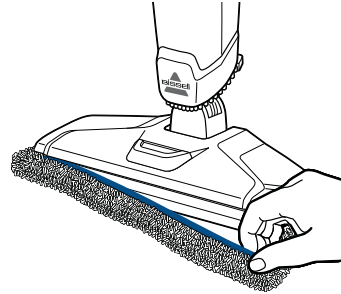

To attach mop pad, wrap mop pad around the bottom of the foot, making sure the gray stitching is located on the front of the foot and the Quick Grip Release™ Tab is located on the back.

Using Scent Discs Tray

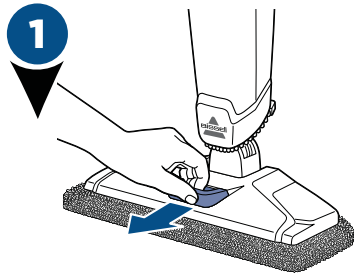

To insert scent discs, pull the tray located on top of mop head out to open.

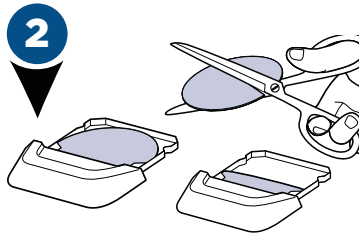

Use whole disc for a refreshing scent or cut disc in half for a lighter scent.

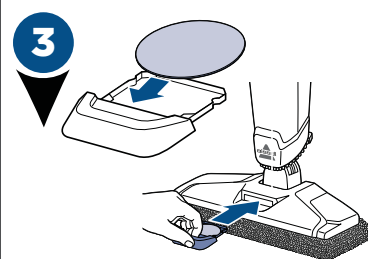

Place scent disc into tray and push tray in to close.

Using SpotBoost™ Brush

- 1** Step down on the pedal located on the back of the machine and lift up to expose the SpotBoost™ Brush located on the bottom of the unit.

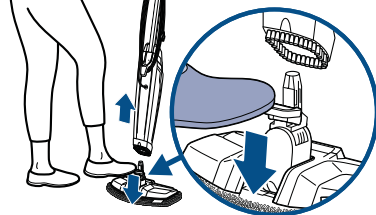

NOTE: Pedal on back of machine is to remove foot and is not a reclining lever.

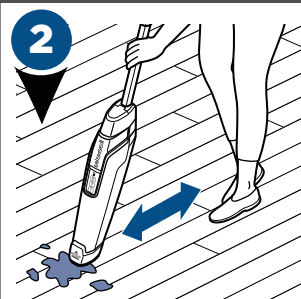

Using the SpotBoost™ Brush, move back and forth to easily clean grout, crevices and sticky messes.

TIP: Turn off the machine before and after using SpotBoost™ Brush to prevent from coming into contact with steam.

⚠️ WARNING

Do not step on the back pedal to recline the unit. When removing the SpotBoost™ Brush, make sure to lift away from your body as the bottom of the brush will release steam.

Using SmartSet™ Steam Control

1

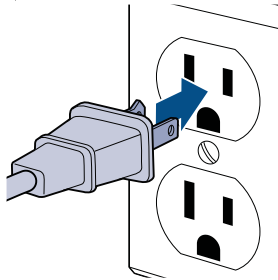

Plug machine into a properly grounded outlet.

2

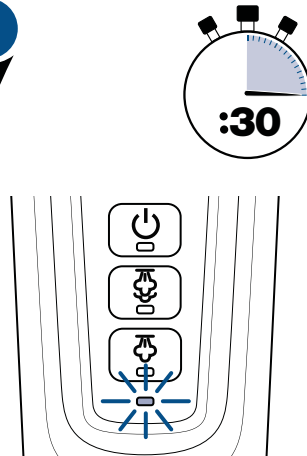

When the unit is plugged in, the Steam Ready light will start to blink. Wait 30 seconds for unit to heat up.

3

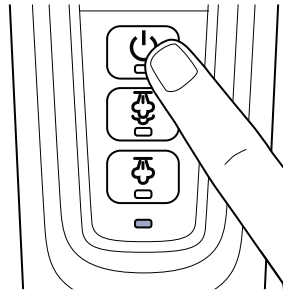

To start cleaning your hard floors, press the STEAM ON/OFF button when the Steam Ready light stops blinking and turns to a solid light.

4

After pressing the STEAM ON/OFF button, select a desired steam level based on your cleaning needs.

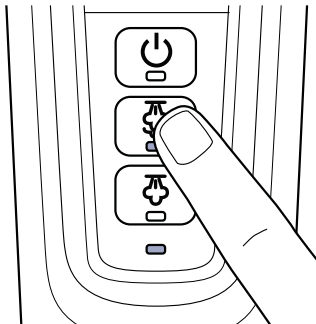

Push the HIGH STEAM button once to turn ON. Use HIGH STEAM when cleaning durable floors or sticky messes.

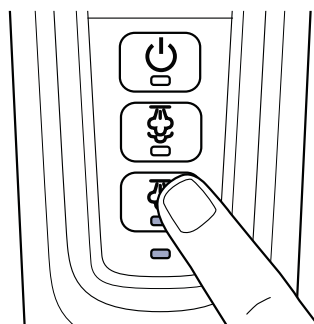

Push the LOW STEAM button once to turn ON. Use LOW STEAM for delicate floors or for light, everyday cleaning.

5

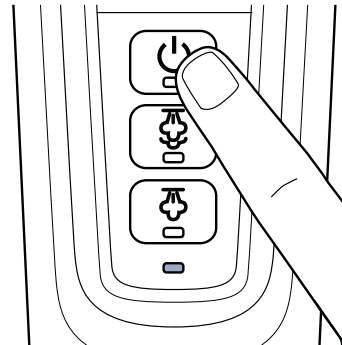

To turn steam off, press the STEAM ON/OFF button once.

NOTE: You must select the STEAM ON/OFF button and wait until the blinking Steam Ready light is a solid color before selecting your steam level. Upon the first use of your steam mop or first use after refilling the water tank, the pump may make a “knocking” sound. This is normal and will diminish after a few seconds.

Operations: Cleaning Your Hard Floors

NOTE: Before you clean, thoroughly sweep or vacuum floor prior to cleaning with the PowerFresh® Deluxe Steam Mop.

YOUR STEAM MOP IS DESIGNED TO CLEAN HARD FLOORING SUCH AS CERAMIC TILE, LAMINATE, MARBLE, STONE AND SEALED HARDWOOD FLOORS. USE OF YOUR STEAM MOP ON WAXED OR SOME UNWAXED FLOORS MAY RESULT IN A DIMINISHED GLOSSINESS. THE STEAM MOP IS NOT FOR USE ON UNSEALED FLOORS. FOR BEST RESULTS, TEST IN AN INCONSPICUOUS AREA AND CHECK THE CARE INSTRUCTIONS FROM YOUR FLOORING MANUFACTURER.

1

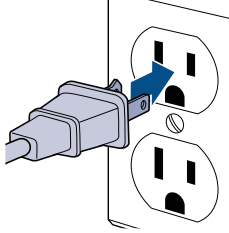

Plug the machine into a properly grounded outlet.

2

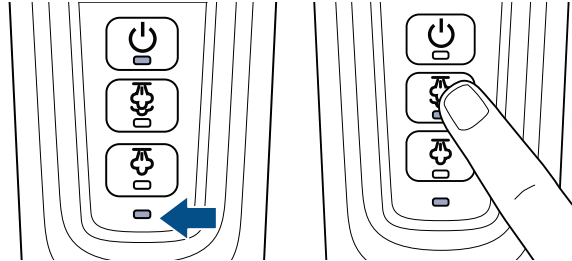

To start cleaning your hard floors, turn the machine ON by pressing the POWER button. Once the blinking Steam Ready light turns solid, select the appropriate steam level.

3

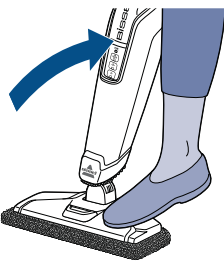

Step on the back of the foot to recline the body of the machine to begin cleaning.

4

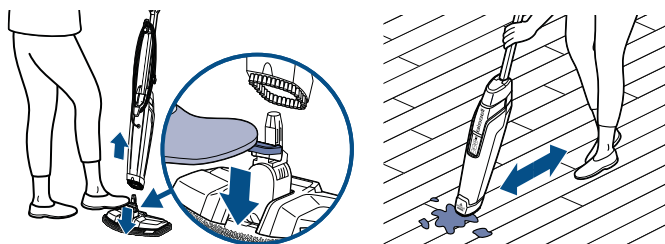

For overly challenging and stuck-on messes, step on the release pedal located on the back of the machine and lift up to use the SpotBoost™ Brush (see page 7).

NOTE: When removing the SpotBoost™ Brush, make sure to lift it away from your body as the bottom of the brush will release steam.

5

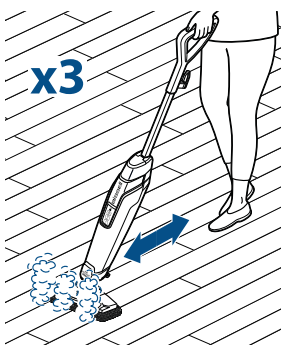

For best results to sanitize an area of your floor, use the microfiber cloth pads and slowly and evenly stroke your steam mop back and forth at least three times over the area using continuous steam. Remove the pad after use and wash.

6

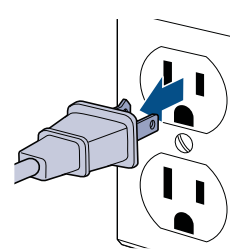

When finished cleaning, turn off the machine by pressing the POWER button and unplugging the unit.

Maintenance: Cleaning Your Steam Mop

WARNING

To reduce the risk of fire, electric shock or injury, turn power OFF and disconnect plug from electrical outlet before performing maintenance or troubleshooting.

1

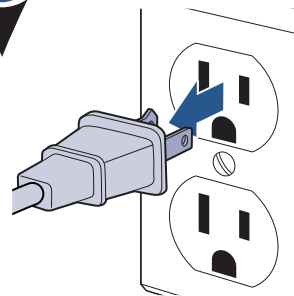

Turn off and unplug the machine from the grounded outlet.

2

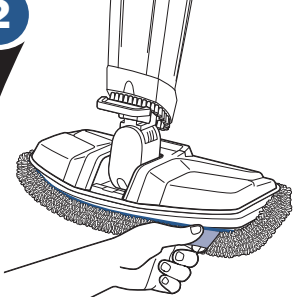

Carefully remove mop pad using the Quick Grip Release Tab from the mop head.

NOTE: Mop pad and lower assembly may be hot.

3

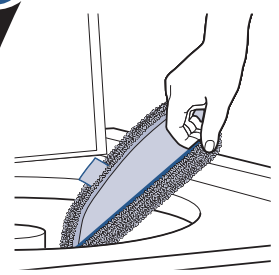

Mop pads can be machine washed in warm water. Use only non-bleach liquid detergents. Do not use fabric softeners or bleach. For best results, air dry.

4



Remove the scent disc from the scent disc tray or replace as needed.

5

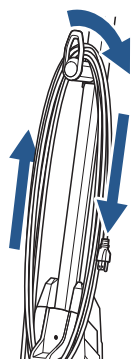

Wrap cord around Quick Release Cord Wrap on the back of the steam mop and wipe all surfaces of the machine with a soft cloth.

6

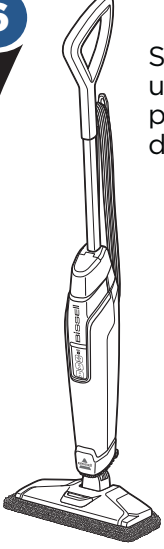

Store upright in a protected, dry area.

Troubleshooting

WARNING

To reduce the risk of electric shock, turn power switch off and disconnect plug from electrical outlet before performing maintenance or troubleshooting checks.

Problem	Possible causes	Remedies
Reduced steam OR no steam	Water tank empty	Refill tank
	Steam level not selected	Select steam level by pushing steam level button
	Scented disc tray not installed properly	Push the scented disc tray all the way into the unit until it's flush
	ON/OFF button not pressed	Select by pushing the POWER button once; Steam Ready light illuminates
Streaking	Dirty mop pad	Remove and wash pad per instructions before further use
	Use on waxed or oiled floor	If you have used floor polishes or wax on your floors, steam products may decrease glossiness. Refer to the wax or polish manufacturer. If you don't wax or polish your floors, check the floor care instructions from your flooring manufacturer.
Leaking	Mop pad is too wet	Remove and replace with dry mop pad
	Steam level is too high	Lower the steam level
	Crack in unit or water tank	Check to see if there are any cracks on the unit or tank and check to make sure the rubber gasket on the tank is still attached and seated properly in the unit
Knocking Noise	First use or water tank is empty	Fill water tank and knocking will diminish after a few seconds

Warranty

This warranty gives you specific legal rights, and you may also have other rights which may vary from state to state. If you need additional instruction regarding this warranty or have questions regarding what it may cover, please contact BISSELL Consumer Care by E-mail, telephone, or regular mail as described below.

Limited Two-Year Warranty

Subject to the *EXCEPTIONS AND EXCLUSIONS identified below, upon receipt of the product BISSELL will repair or replace (with new or remanufactured components or products), at BISSELL's option, free of charge from the date of purchase by the original purchaser, for two years any defective or malfunctioning part.

See information below on "If your BISSELL product should require service".

This warranty applies to product used for personal, and not commercial or rental service. This warranty does not apply to fans or routine maintenance components such as filters, belts, or brushes. Damage or malfunction caused by negligence, abuse, neglect, unauthorized repair, or any other use not in accordance with the User's Guide is not covered.

BISSELL IS NOT LIABLE FOR INCIDENTAL OR CONSEQUENTIAL DAMAGES OF ANY NATURE ASSOCIATED WITH THE USE OF THIS PRODUCT. BISSELL'S LIABILITY WILL NOT EXCEED THE PURCHASE PRICE OF THE PRODUCT.

Some states do not allow the exclusion or limitation of incidental or consequential damages, so the above limitation or exclusion may not apply to you.

***EXCEPTIONS AND EXCLUSIONS FROM THE TERMS OF THE LIMITED WARRANTY** THIS WARRANTY IS EXCLUSIVE AND IN LIEU OF ANY OTHER WARRANTIES EITHER ORAL OR WRITTEN. ANY IMPLIED WARRANTIES WHICH MAY ARISE BY OPERATION OF LAW, INCLUDING THE IMPLIED WARRANTIES OF MERCHANTABILITY AND FITNESS FOR A PARTICULAR PURPOSE, ARE LIMITED TO THE TWO YEAR DURATION FROM THE DATE OF PURCHASE AS DESCRIBED ABOVE.

Some states do not allow limitations on how long an implied warranty lasts so the above limitation may not apply to you.

NOTE: Please keep your original sales receipt. It provides proof of date of purchase in the event of a warranty claim.

Service

If your BISSELL product should require service:

Contact BISSELL Consumer Care to locate a BISSELL Authorized Service Center in your area. If you need information about repairs or replacement parts, or if you have questions about your warranty, contact BISSELL Consumer Care.

Website:

www.BISSELL.com/service-centers

E-mail:

www.BISSELL.com/email-us

Call:

BISSELL Consumer Care
1-800-237-7691
Monday - Friday 8am - 10pm ET
Saturday 9am - 8pm ET
Sunday 10am - 7pm ET

Please do not return this product to the store.

Other maintenance or service not included in the manual should be performed by an authorized service representative.

For any questions or concerns, BISSELL is happy to be of service. Contact us directly at 1-800-237-7691.

Register your product today!

Registering is quick, easy and offers you benefits over the lifetime of your product.

You'll receive:

BISSELL Rewards Points

Automatically earn points for discounts and free shipping on future purchases.

Faster Service

Supplying your information now saves you time should you need to contact us with questions regarding your product.

Product Support Reminders and Alerts

We'll contact you with any important product maintenance reminders and alerts.

Special Promotions

Optional: Register your email to receive notice of offers, contests, cleaning tips and more!

Visit www.BISSELL.com/registration!

Visit us online at: **BISSELL.com**

When contacting BISSELL, have model number of cleaner available.

Please record your
Model Number: _____

Please record your
Purchase Date: _____

NOTE: Please keep your original sales receipt. It provides proof of purchase date in the event of a warranty claim. See Warranty on page 11 for details.

We can't wait to hear from you!

We really do read your comments, tweets, and posts.

Rate this product on BISSELL.com

or any of our retailer sites and let us (and millions of your closest friends) know what you think!

Parts & Supplies

For Parts and Supplies, go to BISSELL.com and enter your model number in the search field.

For cleaning tips and more visit www.BISSELL.com or find us at:



BISSELL



BISSELLClean



BISSELLClean



BISSELL

YouTube

BISSELL



©2017 BISSELL Homecare, Inc
Grand Rapids, Michigan
All rights reserved. Printed in China
Part Number 161-1633 01/17 RevA
Visit our website at: www.BISSELL.com